

Reades



Flat 16, Greenfields Lodge Ferma Lane, Great Barrow

£100,000 Leasehold

Spacious first floor apartment in exclusive semi-rural development • Age restricted development - limited to 55+ & no onward chain • Sought-after village position on the outskirts of Chester City • Two bedrooms, including a large double and good-size single • Featuring electric, programmable storage heater and double-glazing throughout • Comfortable lounge, with fireplace and French doors opening to juliet balcony • Far-reaching views over open countryside and lift to the property • Kitchen/dining room with traditionally styled fitted units • Available with or without furniture, as per photos • Allocated and visitor parking in private car park adjacent to building



Beautifully presented 2-bed flat with open-plan living, modern kitchen, Juliet balcony, countryside views, communal gardens, off-road parking, and classic period charm in a peaceful rural setting.

Council Tax band: B

Tenure: Leasehold

EPC Energy Efficiency Rating: C

EPC Environmental Impact Rating: D

Service charge from April. 2026 onwards will be approx £240 per month

Just to confirm the lift is external, positioned by the front car park, with a seat inside. Disabled parking bay 'badges' can be marked up too - as one resident has one.





Greenfields Lodge, Ferma Lane, Chester
Approximate Gross Internal Area
55 Sq M/592 Sq Ft

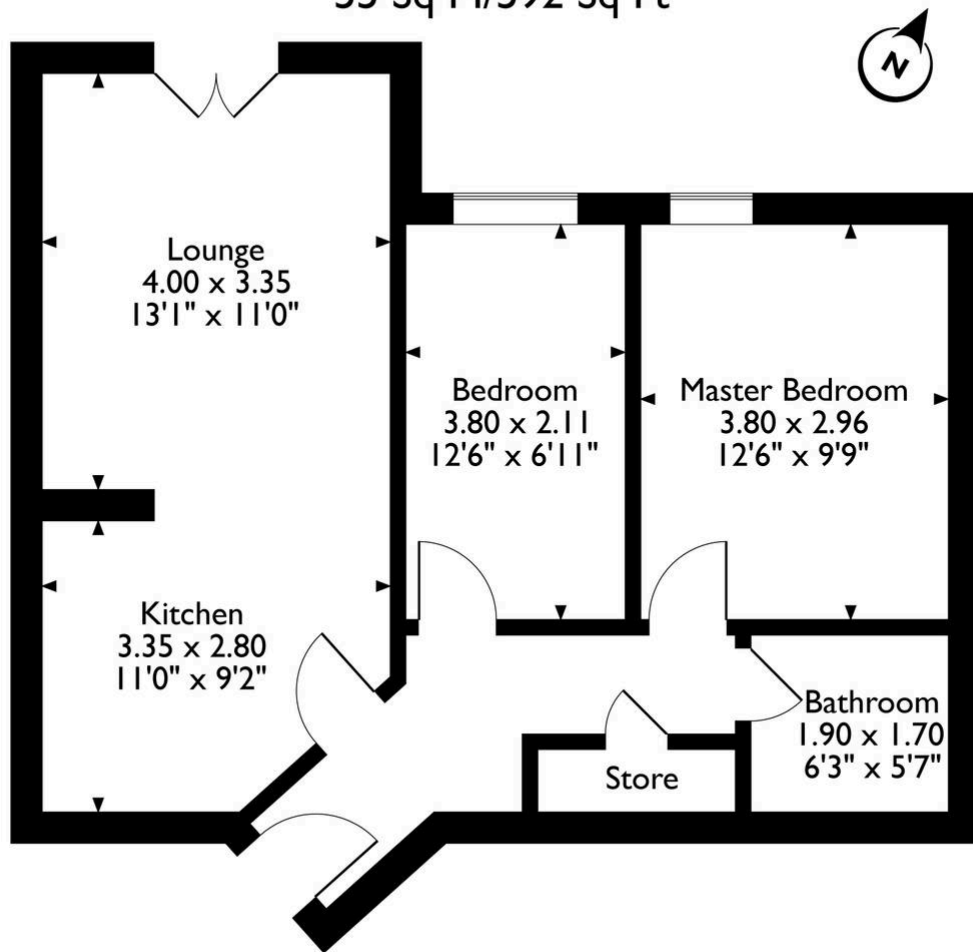

Please note that the location of doors, windows and other items are approximate and this floorplan is to be used for illustrative purposes only. Unauthorized reproduction is prohibited.

You can include any text here. The text can be modified upon generating your brochure.

Contact 01244560745 for a viewing.

Reades

